

Gheen Christoffersen
Mayor

Alice E. Pegram
City Clerk-Treasurer



City of Homedale

PO Box 757
Homedale, Idaho 83628

alicep@cityofhomedale.org

Phone 208-337-4641
Fax 208-337-5904

August 11, 2025

Canyon County
111 N 11th Ave, #310
Caldwell, ID 83605

This letter is to serve as the Letter of Intent form the City of Homedale for the Area of City Impact. Homedale is not proposing any changes to their current Area of City Impact and would be asking to keep the current AOI.

In accordance with Idaho Code 67-6526, the city has reviewed their current AOI and has confirmed the following:

1. The City of Homedale's current AOI is reflective of the areas where growth and development is currently happening and where growth and development is expected to continue over the next 5 years.
2. The boundaries of the current AOI does not exceed 2 miles outside of Homedale city limits and does not overlap with Wilder or Caldwell.
3. The City of Homedale already provides water service to a handful of properties within the AOI with the ability to add more.
4. The City would be able to provide sewer services and street maintenance if a developer was to come into the AOI and develop that infrastructure.
5. The Homedale Rural Fire Department & Homedale Ambulance Service both extend into the AOI already.

Sincerely,









Alice E. Pegram
City Clerk/Treasurer

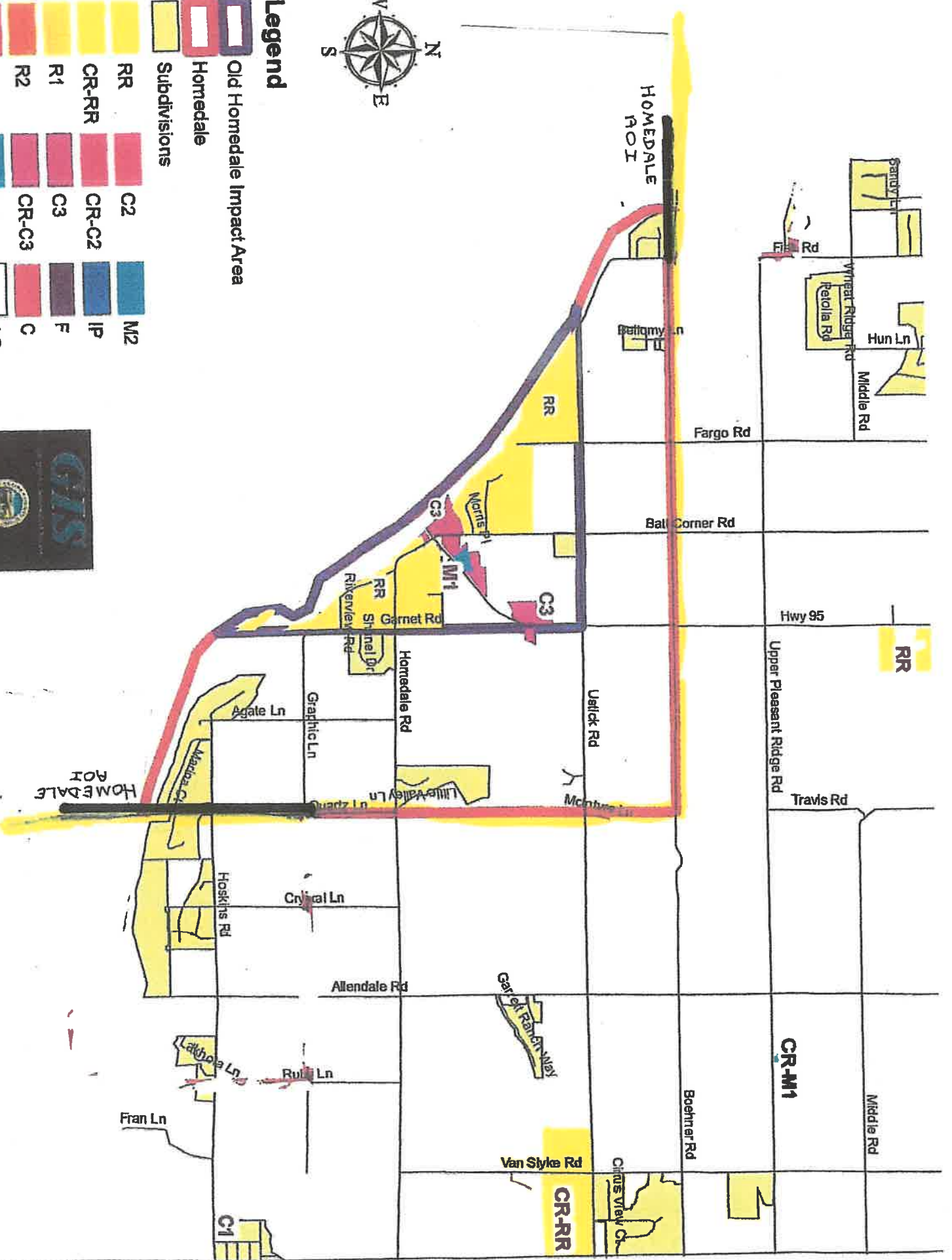

Legend

- Old Homedale Impact Area
- Homedale
- Subdivisions
- RR
- CR-RR
- R1
- R2
- C1
- CR-C1
- C2
- CR-C2
- C3
- CR-C3
- C
- M1
- CR-M1
- M2
- IP
- F
- AG



-  EXISTING IMPACT AREA
-  P & Z RECOMMENDATION
-  CITIES PROPOSED IA
-  CANYON CO RECOMMENDED IA
-  CITY LIMITS



DRAWN ON: MAY 28, 2007
DRAWN BY: MICHAEL BERNICK



HOMEDALE IMPACT AREA MAP

